

# HUSH BOTTOM OFFSET PATCH FITTING EXTENDED T/S DROP DOWN SEALS

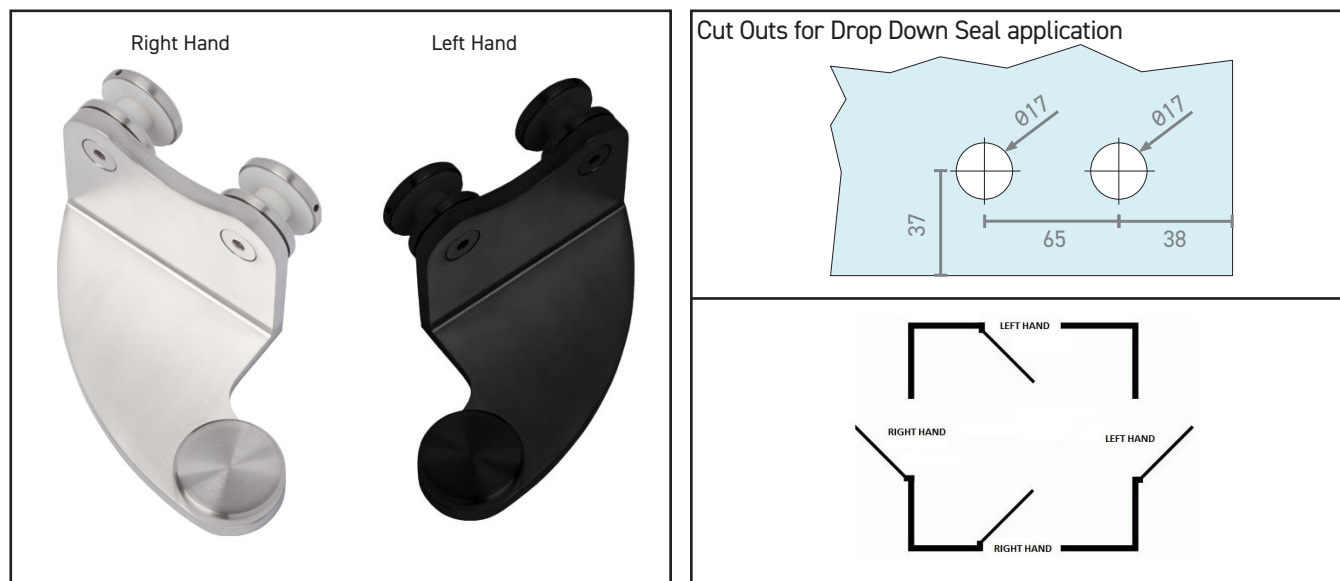

## Product Specification

Offset Bottom Patch Fitting  
To suit H profile drop down seal  
700 Series and 800 Series

Product Code	Handed	Finish	Glass Thickness	Opening Angle	Type
570.6030.01	Right Hand	Satin Stainless Steel	10-12mm	180 degrees	Glass to Wall
570.6040.01	Left Hand	Satin Stainless Steel			
570.6030.39	Right Hand	Black			
570.6040.39	Left Hand	Black			

When fitting HUSH fittings to double doors, please note the following.

- When doors 800mm each, gap at closed position needs to be 11mm
- When doors 850mm each, gap at closed position needs to be 10.5mm
- When doors 900mm each, gap at closed position needs to be 10mm
- When doors 950mm each, gap at closed position needs to be 9.5mm
- When doors 1000mm each, gap at closed position needs to be 9mm

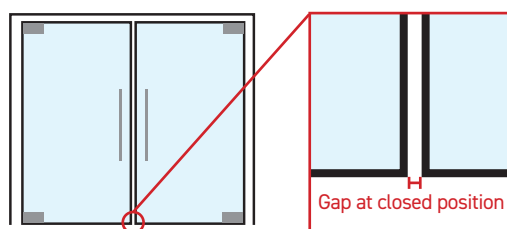

Cut out details for the top & bottom patch fittings are the same, this is not an error top & bottom glass cut outs are the same. The deduction from bottom is to accommodate the H profile drop seal of 21mm is offset exactly by the 21mm height extension.

V6-05122025

# HUSH - OFFSET TOP PATCH FITTING

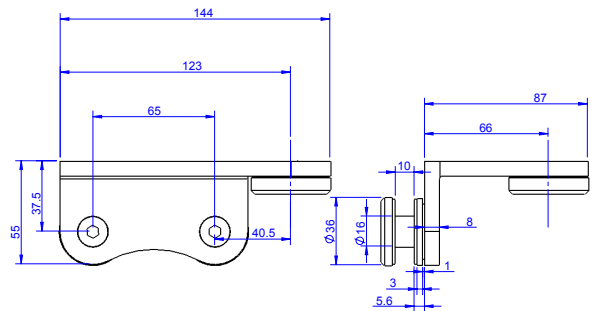
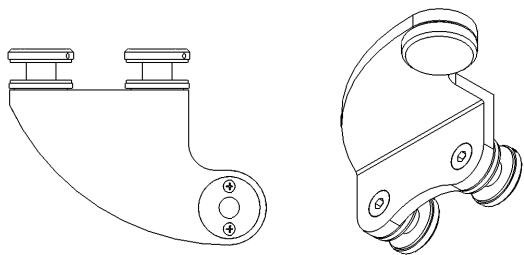
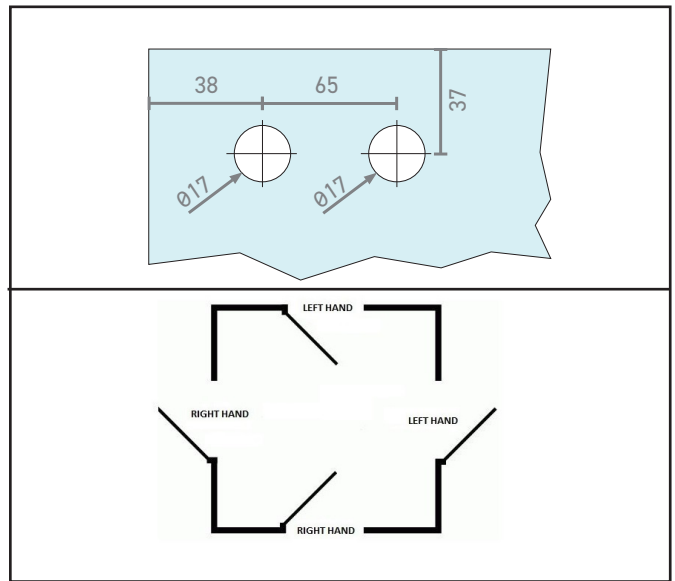

Product Code	Handed	Finish	Glass Thickness	Opening Angle	Type
570.6050.01	Right Hand	Satin Stainless Steel	10-12mm	180 degrees	Glass to Wall
570.6060.01	Left Hand	Satin Stainless Steel			
570.6050.39	Right Hand	Black			
570.6060.39	Left Hand	Black			

When fitting HUSH fittings to double doors, please note the following.

- When doors 800mm each, gap at closed position needs to be 11mm
- When doors 850mm each, gap at closed position needs to be 10.5mm
- When doors 900mm each, gap at closed position needs to be 10mm
- When doors 950mm each, gap at closed position needs to be 9.5mm
- When doors 1000mm each, gap at closed position needs to be 9mm

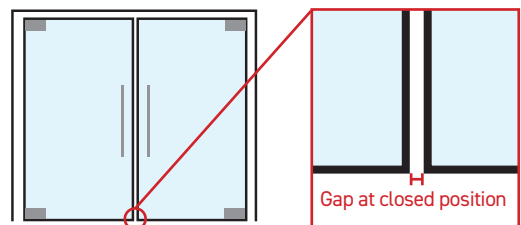

Cut out details for the top & bottom patch fittings are the same, this is not an error top & bottom glass cut outs are the same. The deduction from bottom is to accommodate the H profile drop seal of 21mm is offset exactly by the 21mm height extension.

V6-05122025

# HUSH BOTTOM OFFSET PATCH FITTING

## NOT FOR USE WITH DROP DOWN SEALS

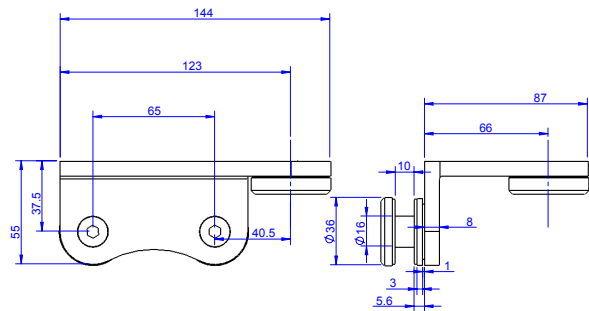
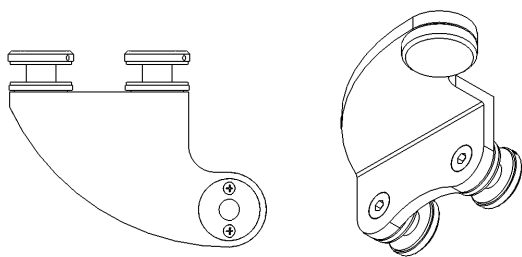
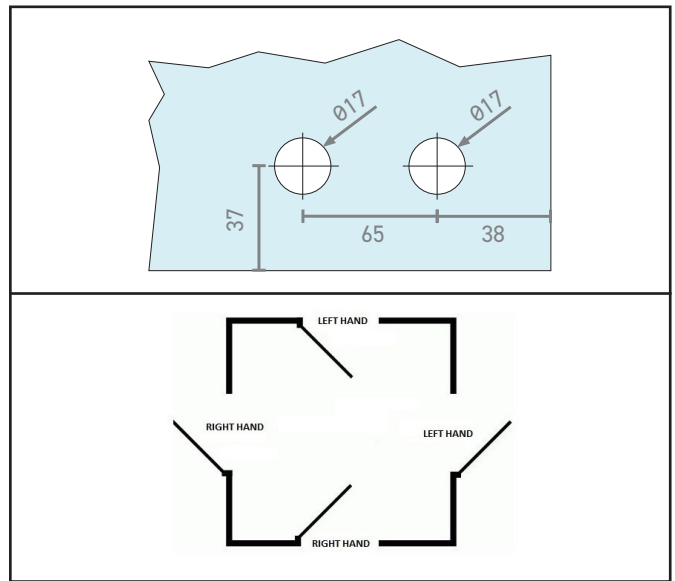

Product Code	Handed	Finish	Glass Thickness	Opening Angle	Type
570.6150.01	Right Hand	Satin Stainless Steel	10-12mm	180 degrees	Glass to Wall
570.6160.01	Left Hand	Satin Stainless Steel			
570.6150.39	Right Hand	Black			
570.6160.39	Left Hand	Black			

When fitting HUSH fittings to double doors, please note the following.

- When doors 800mm each, gap at closed position needs to be 11mm
- When doors 850mm each, gap at closed position needs to be 10.5mm
- When doors 900mm each, gap at closed position needs to be 10mm
- When doors 950mm each, gap at closed position needs to be 9.5mm
- When doors 1000mm each, gap at closed position needs to be 9mm

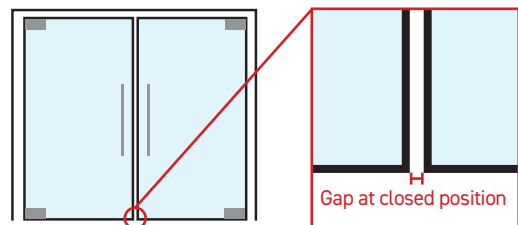

Cut out details for the top & bottom patch fittings are the same, this is not an error top & bottom glass cut outs are the same. The deduction from bottom is to accommodate the H profile drop seal of 21mm is offset exactly by the 21mm height extension.

V6-05122025

# HUSH OFFSET TOP CENTRE PIVOT

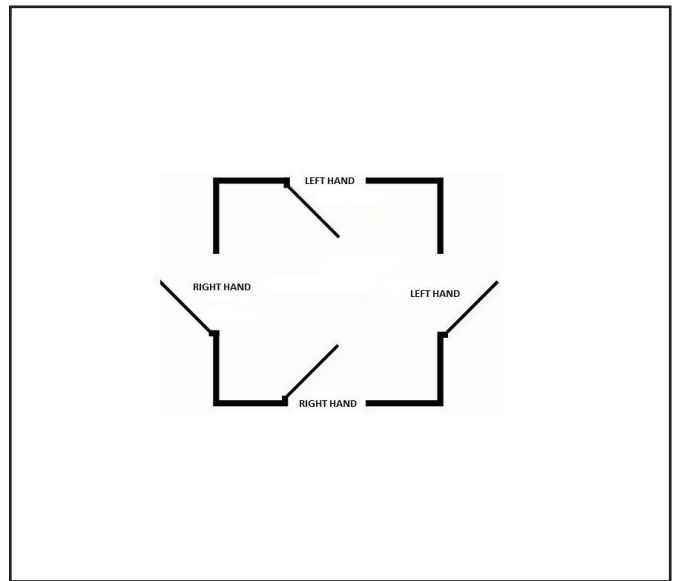

## Product Specification

HUSH – Quiet movement patch fittings, to suit a H profile drop down seal

Suitable for glass-to-glass applications

Can be installed so that a glass door in a glass wall can swing 180degrees

Product Code	Handed	Finish	Glass Thickness	Opening Angle	Type
570.6070.01	Right Hand	Satin Stainless Steel	10-12mm	180 degrees	Glass to Glass
570.6080.01	Left Hand	Satin Stainless Steel			
570.6070.39	Right Hand	Black			
570.6080.39	Left Hand	Black			

When fitting HUSH fittings to double doors, please note the following.

- When doors 800mm each, gap at closed position needs to be 11mm
- When doors 850mm each, gap at closed position needs to be 10.5mm
- When doors 900mm each, gap at closed position needs to be 10mm
- When doors 950mm each, gap at closed position needs to be 9.5mm
- When doors 1000mm each, gap at closed position needs to be 9mm

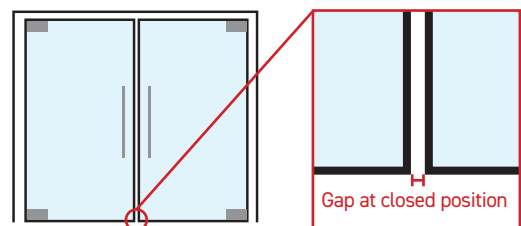

V6-05122025

For more information please contact

01451 824110 | sales@wellinguk.com | www.wellinguk.com

Welling Ironmongery Ltd, Unit R1, Bourton Industrial Park, Bourton on the Water GL54 2HQ