

Product Code	Finish	Door Type	Fitting	Anti-Jump	Rail Length	Max Door Weight per door leaf	Glass Thickness	Included	
570.6004.01	Satin Stainless Steel	Single	Non -Countersunk	Yes	2500mm	100kg	10-12mm	5 x Tracker Holder (Glass to Glass)	2 x Door Stop (Left & Right)
570.6004.39	Matt Black							2 x End Socket	1 x Rail
								2 x Roller	
570.6005.01	Satin Stainless Steel	Double	Non -Countersunk	Yes	5000mm	100kg	10-12mm	10 x Tracker Holder (Glass to Glass)	4 x Door Stop (2 Left & 2 Right)
570.6005.39	Matt Black							2 x End Socket	2 x Rail
								4 x Roller	1 x Tube Connector

Product Code	Finish	Fitting	Anti-Jump	Glass Thickness	Sold as
570.6130.01	Satin Stainless Steel	Non -Countersunk	Yes	10-12mm	Each
570.6130.39	Matt Black				

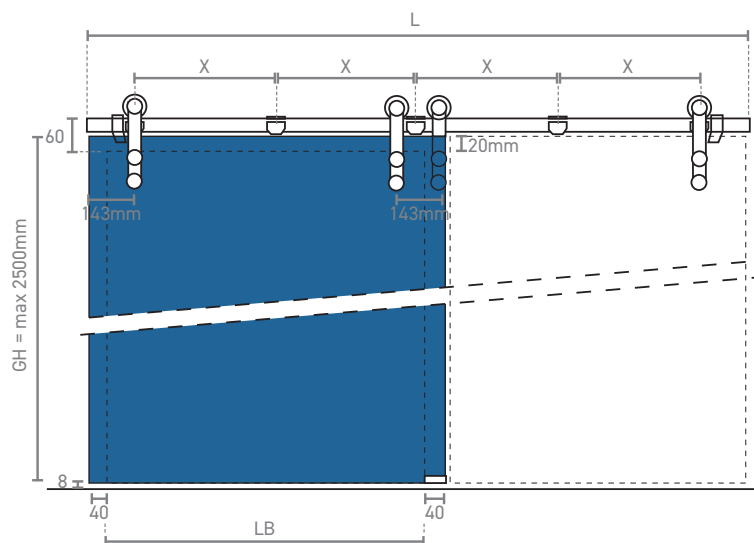
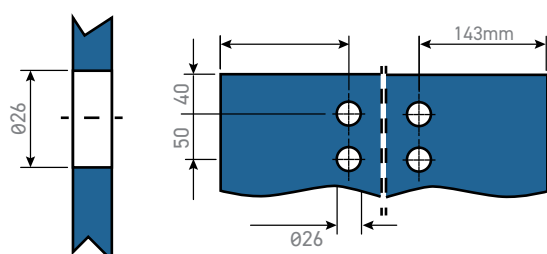
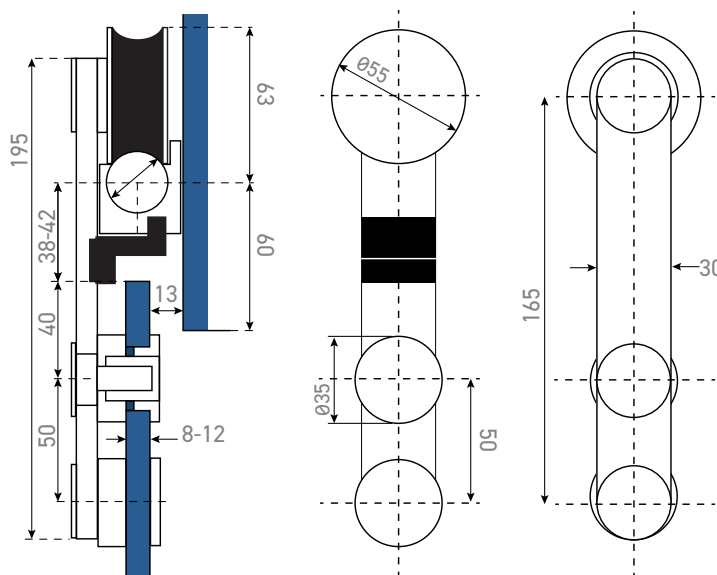

Welling Ironmongery Ltd, Unit R1, Bourton Industrial Park, Bourton on the Water GL54 2HQ

SG ANTI JUMP TRACK HOLDER - GLASS TO GLASS

Product Code	Type	Fitting	Glass Thickness	Finish
570.6116.01	Glass to Glass	Non -Countersunk	10-12mm	Satin Stainless Steel
570.6116.39	Glass to Glass	Non -Countersunk	10-12mm	Matt Black

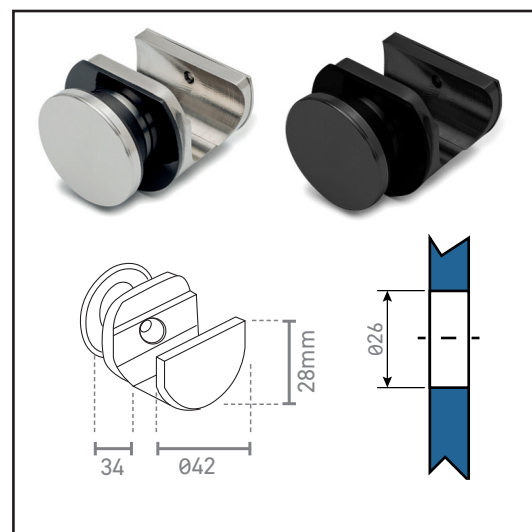

SG ANTI JUMP TRACK HOLDER - GLASS TO WALL

Product Code	Type	Fitting	Glass Thickness	Finish
570.6117.01	Glass to Wall	Non -Countersunk	10-12mm	Satin Stainless Steel
570.6117.39	Glass to Wall	Non -Countersunk	10-12mm	Matt Black

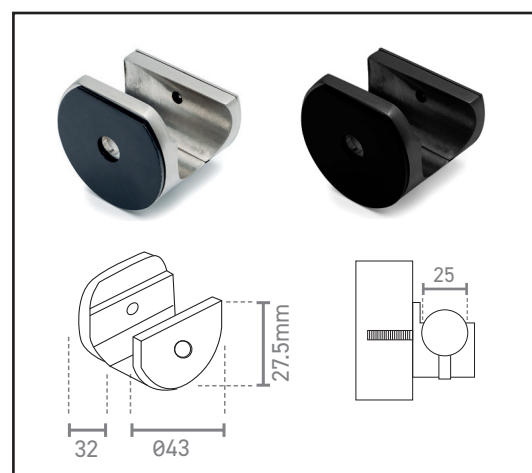

SG STANDARD DOOR STOP

Product Code	Finish	Finish
570.6122.01	Left Hand	Satin Stainless Steel
570.6123.01	Right Hand	
570.6122.39	Left Hand	Matt Black
570.6123.39	Right Hand	

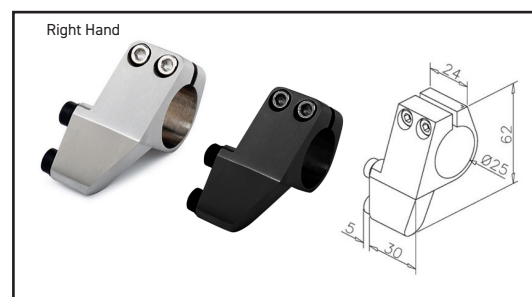
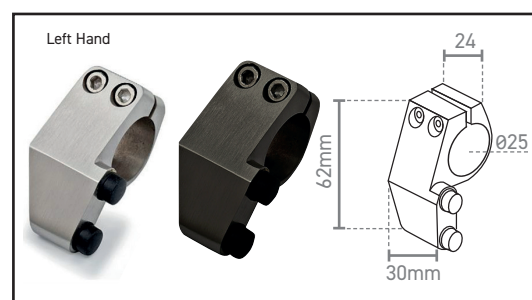

SG BOTTOM DOOR GUIDE

Product Code	Finish	Glass Thickness
570.6109.01	Satin Stainless Steel	10-12mm
570.6109.39	Matt Black	

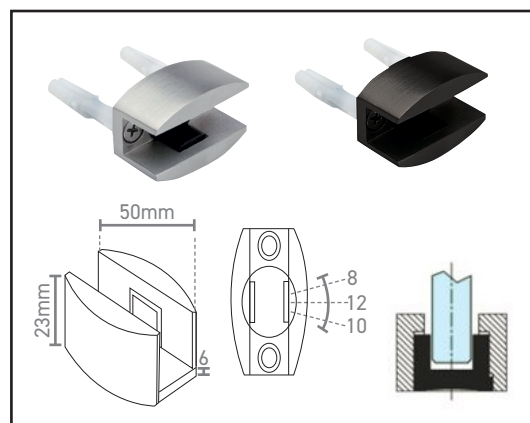

SG SLIDING RAIL TUBE

Product Code	Finish	Product	Length	DIA	Wall Thickness
570.8925.01	Satin Stainless Steel	Tube	2500mm	25mm	3mm
570.8925.39	Matt Black				

3mm wall thickness is very strong, rigid and suitable for door's up to 100kg each. (2 x 100kg max on double doors). When fitting double doors with glass overpanels, ensure the overpanels are fixed securely, otherwise this adds additional load bearing to the sliding rail tube

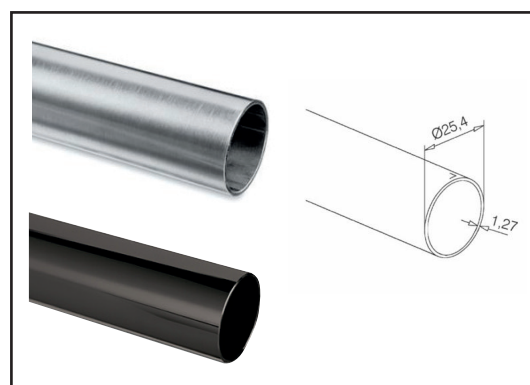

SG END CAPS

Product Code	Finish	Product	Type	Sold as
570.0729.01	Satin Stainless Steel	End Cap	Tubular Rail	Each
570.0729.39	Matt Black			

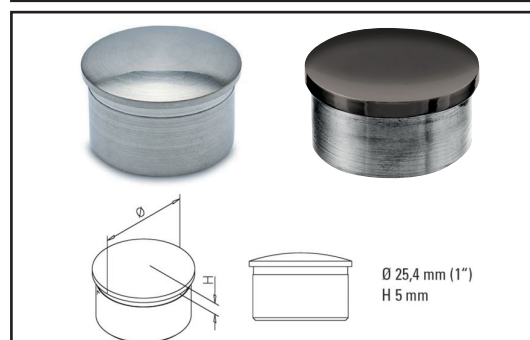

SG TUBE CONNECTOR

Product Code	Finish	Product
570.8901.01	Satin Stainless Steel	Inner Tube

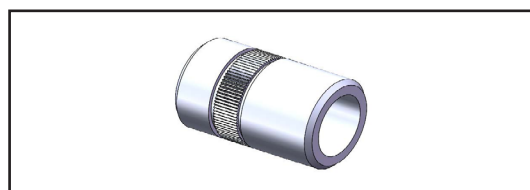

SG END SOCKET

Product Code	Finish	Product	Type
570.1729.01	Satin Stainless Steel	End Socket	Wall Fixing



SG SYSTEM PIN WRENCH TOOL - ADJUSTABLE

Product Code	Fitting
570.6999.01	Adjustable

Fitting countersunk and non-countersunk fittings

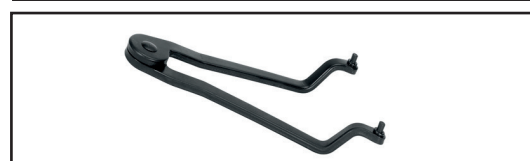

For more information please contact

01451 824110 | sales@wellinguk.com | www.wellinguk.com

Welling Ironmongery Ltd, Unit R1, Bourton Industrial Park, Bourton on the Water GL54 2HQ