

FORTIS - 180 DEGREE OPENING HYDRAULIC SELF CLOSING & BACKCHECK HINGES

Product Code	Finish	Hinge Type	Hinge Function 0° to 90°	Hinge Function 90° to 180°	Type
570.8461.01	Satin Stainless Steel	Hydraulic - Self Close	Self closing	Free Swinging	Glass to Frame
570.8461.39	Black				
570.8469.01	Satin Stainless Steel	Hydraulic - Backcheck	Free Swinging	Backcheck starts at 110°	
570.8469.39	Black				

- Recommended installation one hydraulic self closing hinge (at bottom of door) and one backcheck installed at top of door.
- One 8461 Hydraulic self closing hinge (2nm force per hinge) has the same closing force as two 0845 Hydraulic hinges (1nm force per hinge)
- Hydraulic self closing hinge is speed adjustable. (See page 3 for instruction manual on how to adjust) Adjustable range, meaning post installation adjustment to the pretension angle.
- Hydraulic backcheck hinge is power adjustable (but not range adjustable)
- If two hydraulic self closing hinges are installed (8461 x2) the door will not slam shut, but have a high opening and closing force.
- Max Door Weight 100kg for 2 or 3 Hinges
- Max Door Width 1000mm
- Glass Door Thickness 10-12mm

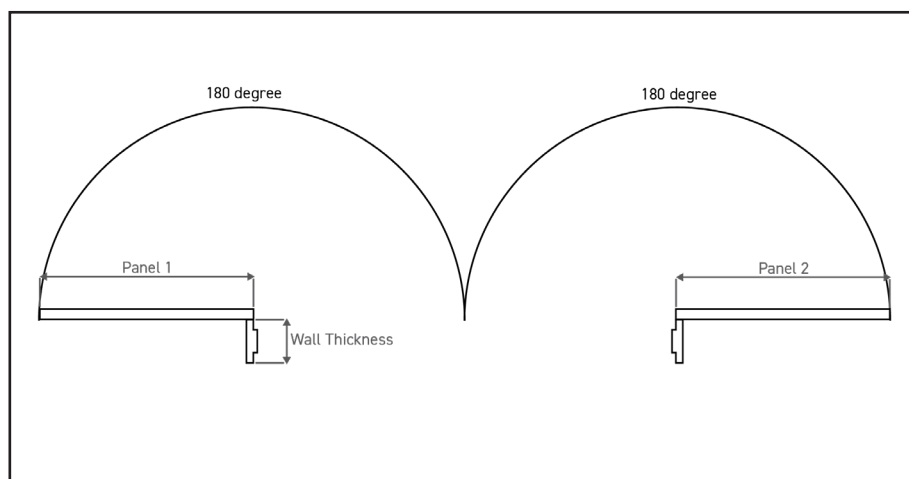
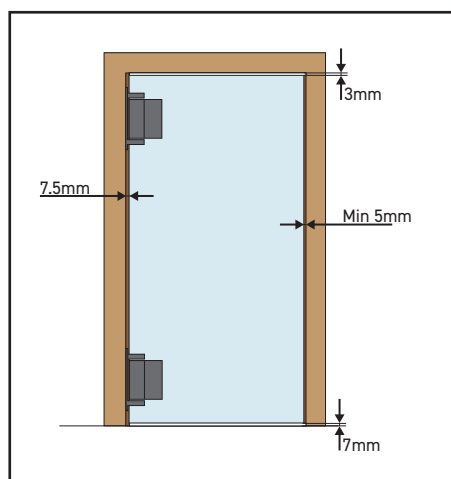

For more information please contact

01451 824110 | sales@wellinguk.com | www.wellinguk.com

Welling Ironmongery Ltd, Unit R1, Bourton Industrial Park, Bourton on the Water GL54 2HQ

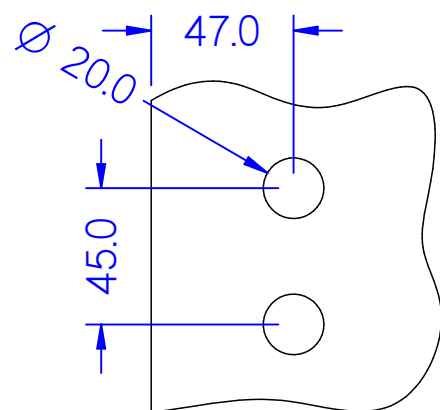
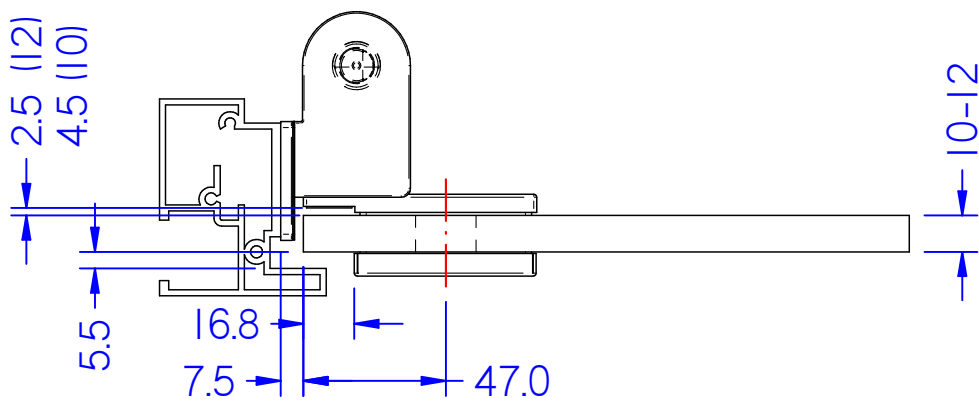

ATTENTION: When fitting with U channel, please make a compensating adjustment to the glass cut out positions!!!

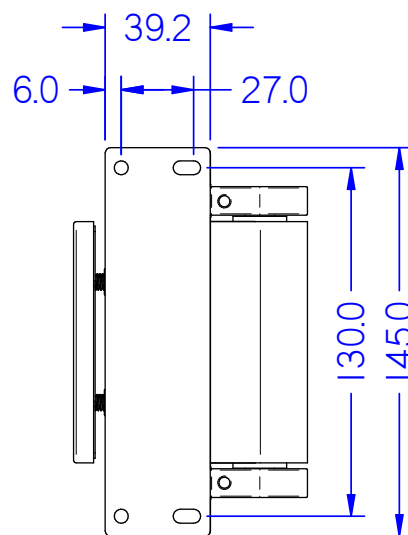
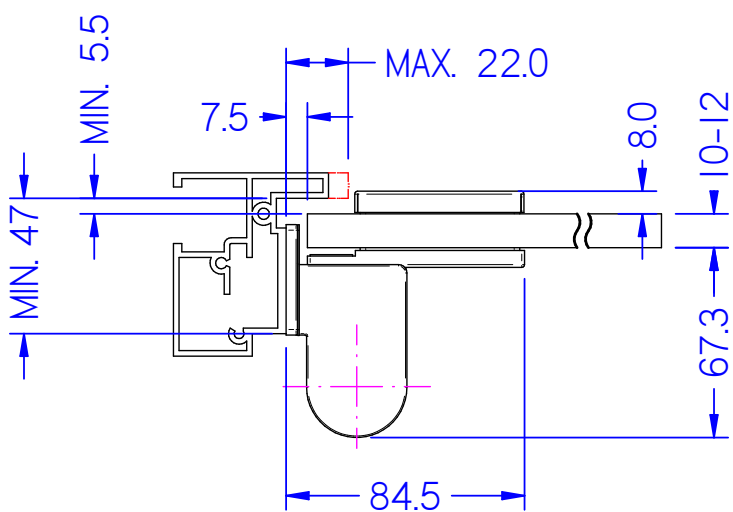
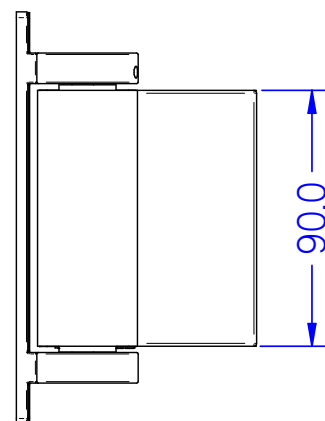
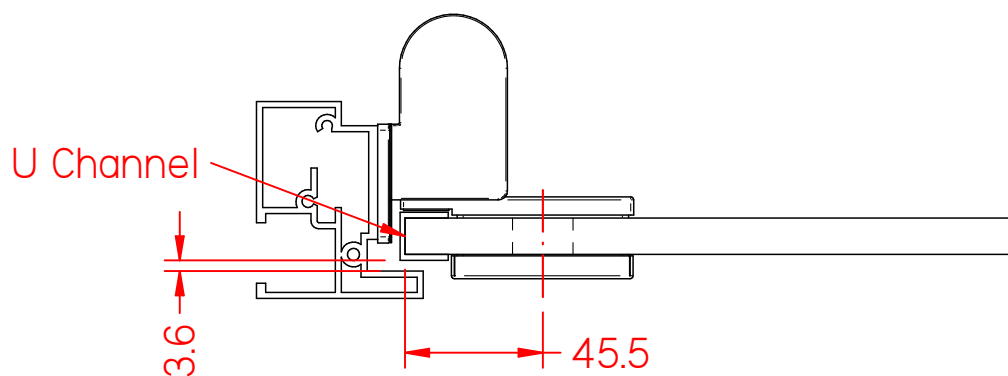
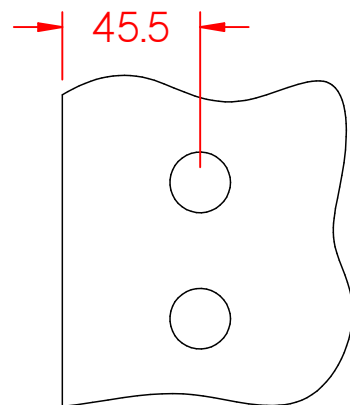

Hydraulic Hinge Installation Instruction

FORTIS

By **DNW**

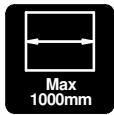
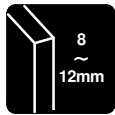

⚠ Tempered glass only

STEP1

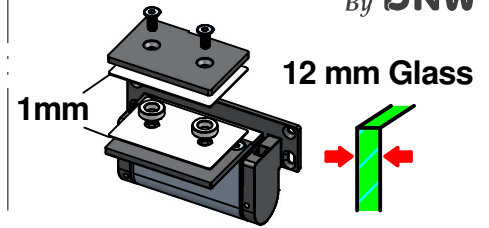
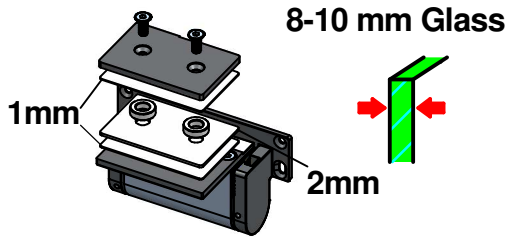
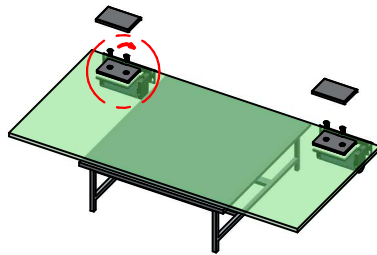

**TSG 10-15N.m.
LSG 5N.m, MAX. door weight 60Kgs**

STEP2

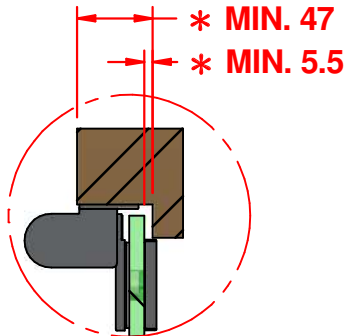
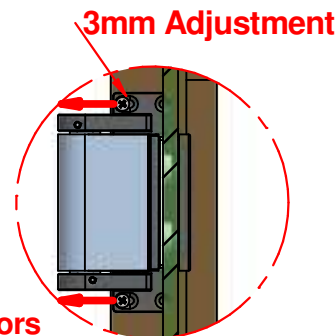
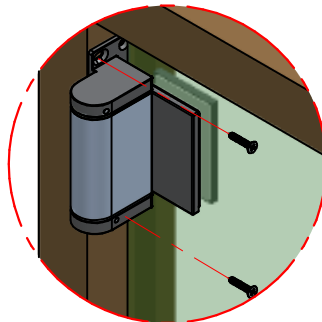
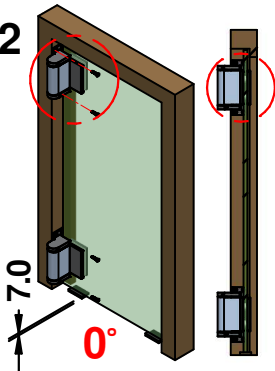

⚠ Please use suitable anchors & screws for your frame

STEP3

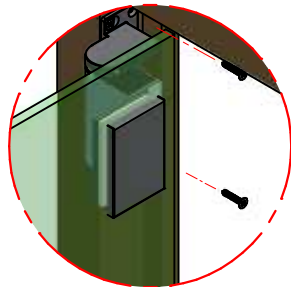
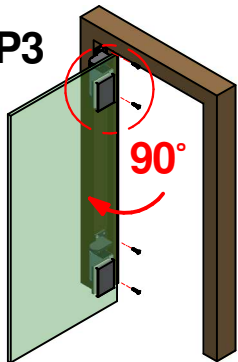

⚠ Please use suitable anchors & screws for your frame

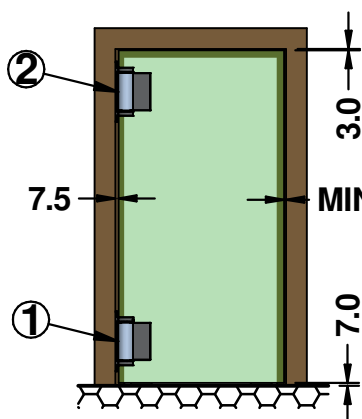
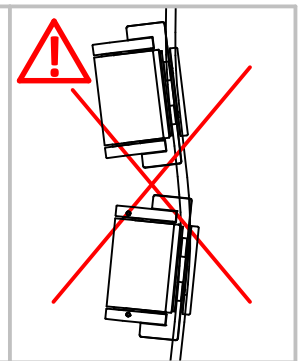
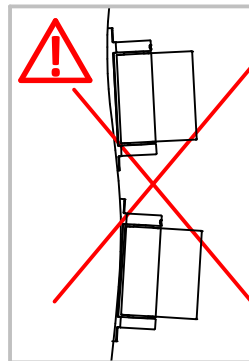

① Closing Speed Adjustable ② Backcheck Force Adjustable

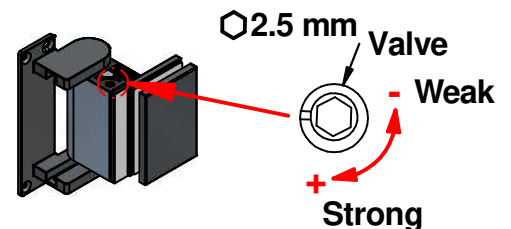
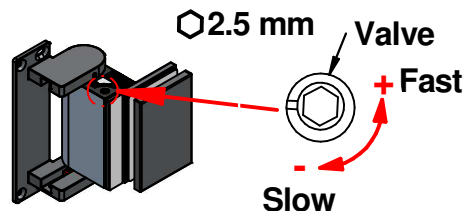

⚠ Max. 1-1/4 turn from closed

*** How to adjust the closing speed :**

Always turn 1/4 turn at a time until the door closes at desired speed.

1. Turning the valve clockwise to slow down the closing speed.
 2. Turning the valve counterclockwise to speed up the closing speed.
- *stop turning the valve protruding over the pivot block, or it will hit the bottom plate and cause damage.**

⚠ WARNING : No any oil needed , or it will damage the hinge and cause noise.

Glass Cut-out

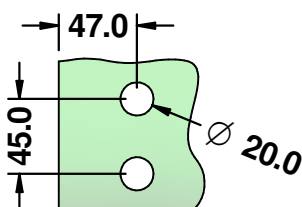

Steps to adjust while the door is not closed against frame

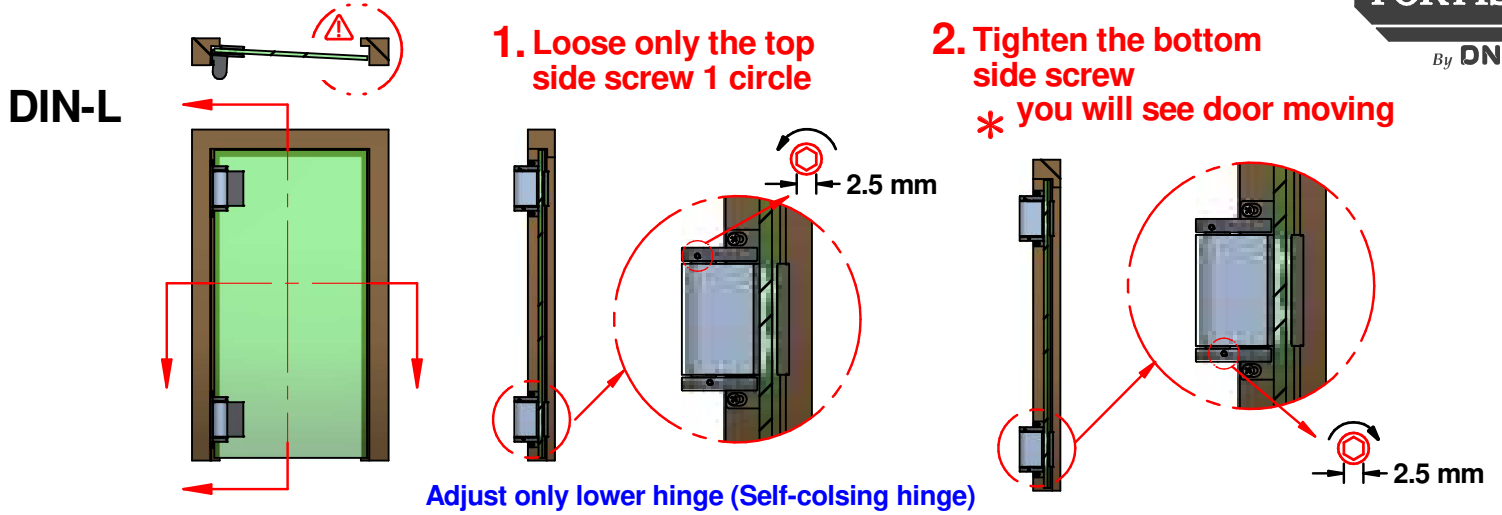

3. Tighten the top side screw

4.

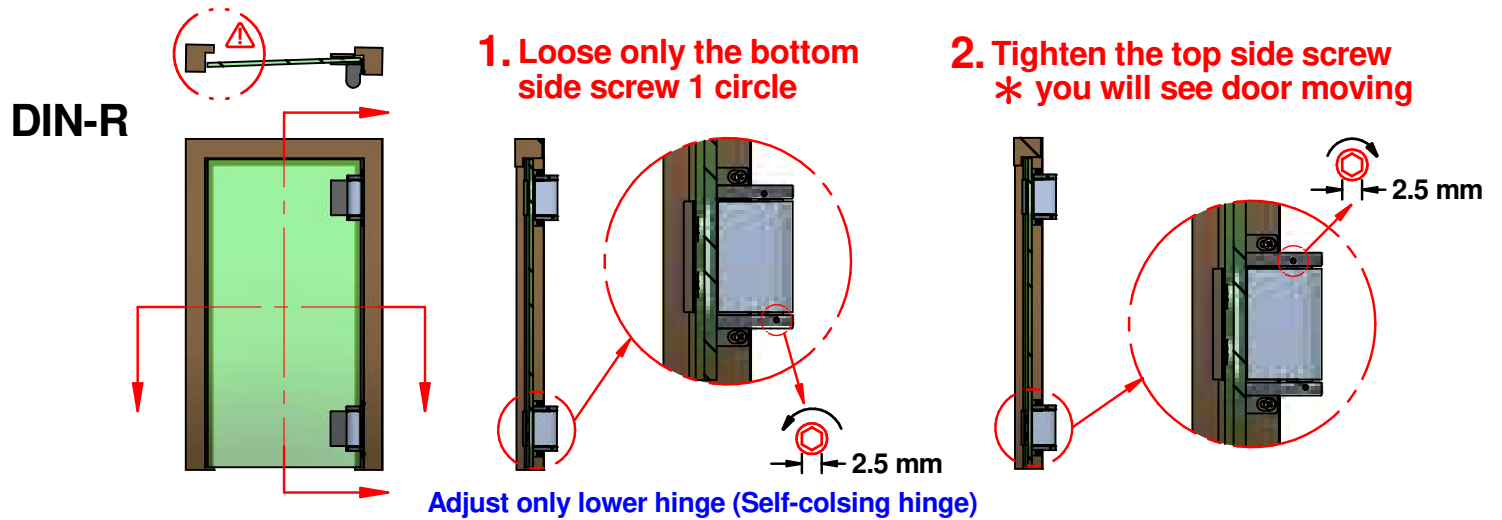
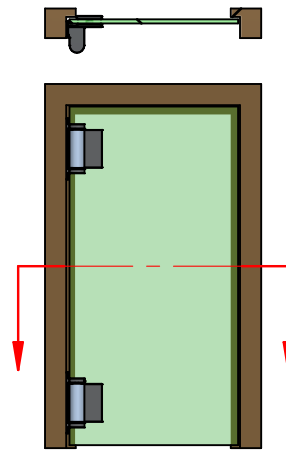
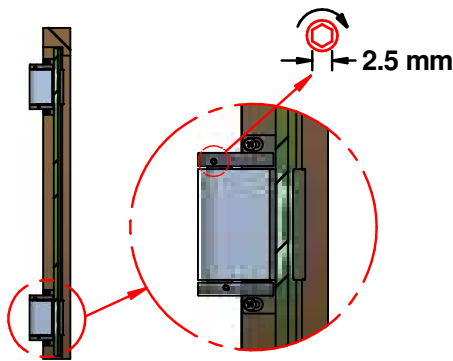

3. Tighten the bottom side screw

4.

