

570.0606.01

Horizontal Patch Latch without Levers - Satin Stainless Steel

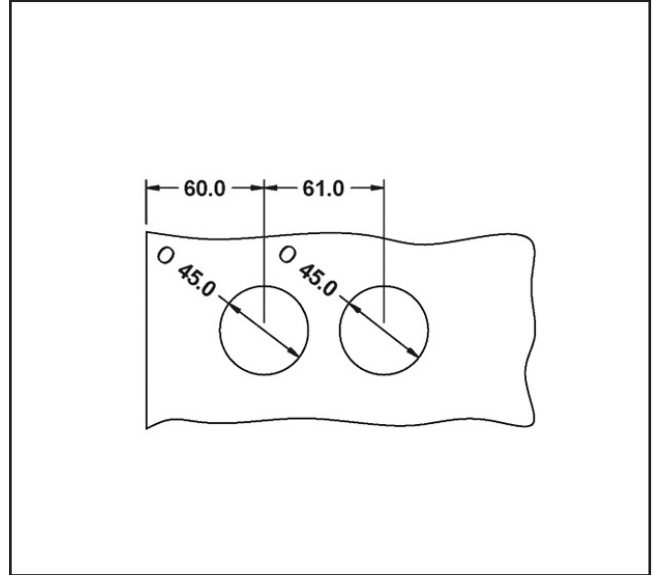
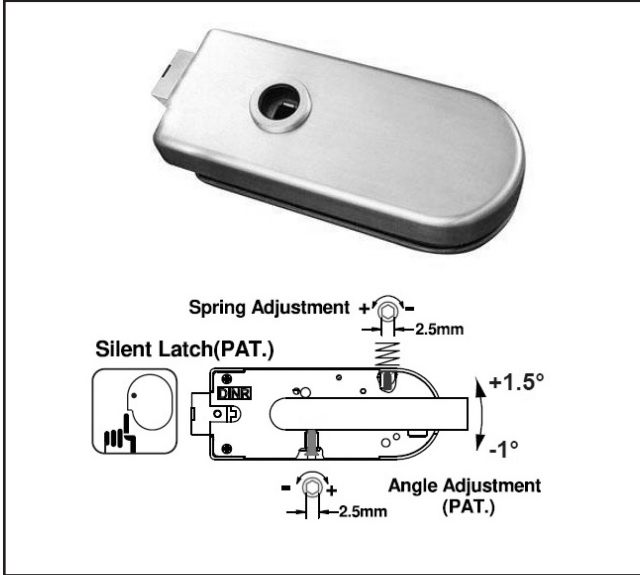

Product Specification

Horizontal Patch Latch (without Levers) with lever at front of fitting, not rear.

Specification

| | |
|-------------------|---------------------------|
| Finish | Satin Stainless Steel |
| Glass Thickness | 8-12mm |
| Levers Included | No - see code 570.7740.01 |
| Cylinder Included | No |
| Tested | EN12209 |
| Cylce Tested | 200,000 cycles |
| | |

For more information please contact

01451 824110 | sales@wellinguk.com | www.wellinguk.com

Welling Ironmongery Ltd, Unit R1, Bourton Industrial Park, Bourton on the Water GL54 2HQ