

530.1550.01

GEZE TS550 NV EN3-6 Floorspring and Spindle without Cover

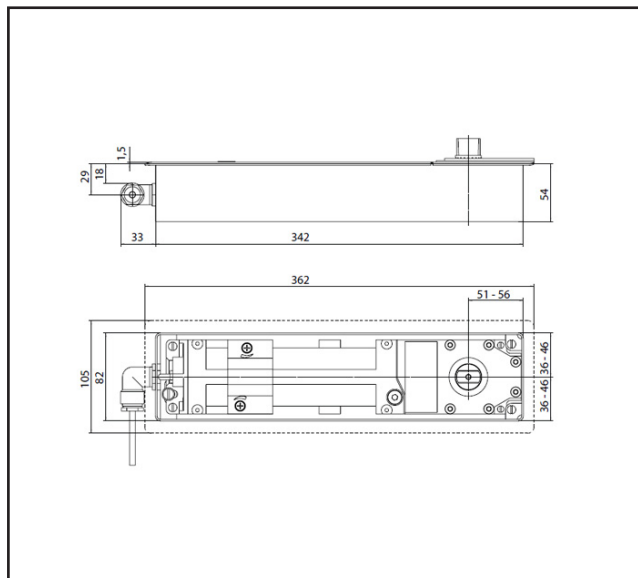

Product Specification

Floor spring for single leaf single and double-action doors of up to 1400 mm leaf width with adjustable closing force EN 3-6 and with hold-open function that can be switched on and off. Can be used for right and left hand doors without conversion. Delayed closing adjustable to adapt the closing force of the door up to approx 80° opening angle. Mechanical hold-open unit in the door closer with hold-open. Hydraulic latching action which accelerates the door shortly before it is closed. Closing speed can be individually adjusted.

Specification

Brand	GEZE
Power	EN3-6
Max Door Width	1400mm
Max Door Weight	300kg
Spindle Included	Yes
Cover Included	No
Backcheck	Mechanical
Hold Open	Yes
Adjustable closing speed	Yes
Latching action adjustable	Yes
Hold open range	85° - 165°
Opening angle	170°

For more information please contact

01451 824110 | sales@wellinguk.com | www.wellinguk.com

Welling Ironmongery Ltd, Unit R1, Bourton Industrial Park, Bourton on the Water GL54 2HQ