

# 640.2114.01

Easi-T Mortice Nightlatch Case - Euro Profile - 76mm

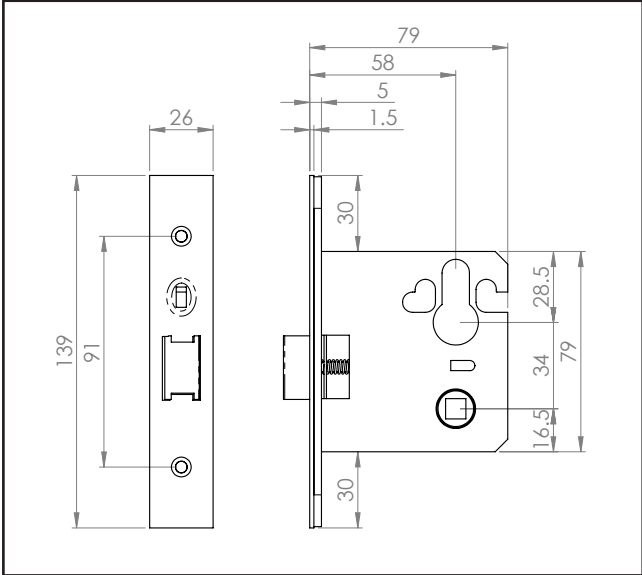

Making Ironmongery Easy



## Product Specification

Ideal for use with electric strikes and in situations where key operation is required from 1-side without lever handles  
 Small case, suits euro profile cylinder  
 Holdback/passage function via small lever on front of lock

Comes complete with Strike Plate and Dust Box.  
 Please note standard application has the cylinder above the lever handle, with the cylinder upside down, and the lever operating downwards.

## Specification

Finish	Satin Stainless Steel
Case Depth	78mm
Backset	58mm
Reversible	Yes
Radius/Square	Square
Dust Box Included	Yes