

Technische Daten:
Türscharnier - 2702

Datasheet:
Door hinge - 2702

Art. 45.2702.000.10

Art. 45.2702.000.12

Art. 45.2702.000.26

Stand 09.2019

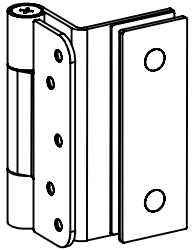

Ausführung:
Options:

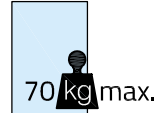
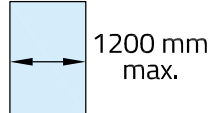
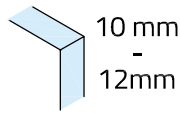

Material: V2A
Material: Stainless steel AISI 304

Gewicht: / Weight: 0,645 kg

Oberflächen:
Finish: Edelstahl-Design
Stainless steel design

Chrom-Design
Chrome design

Anthrazit-Design
Anthracite design

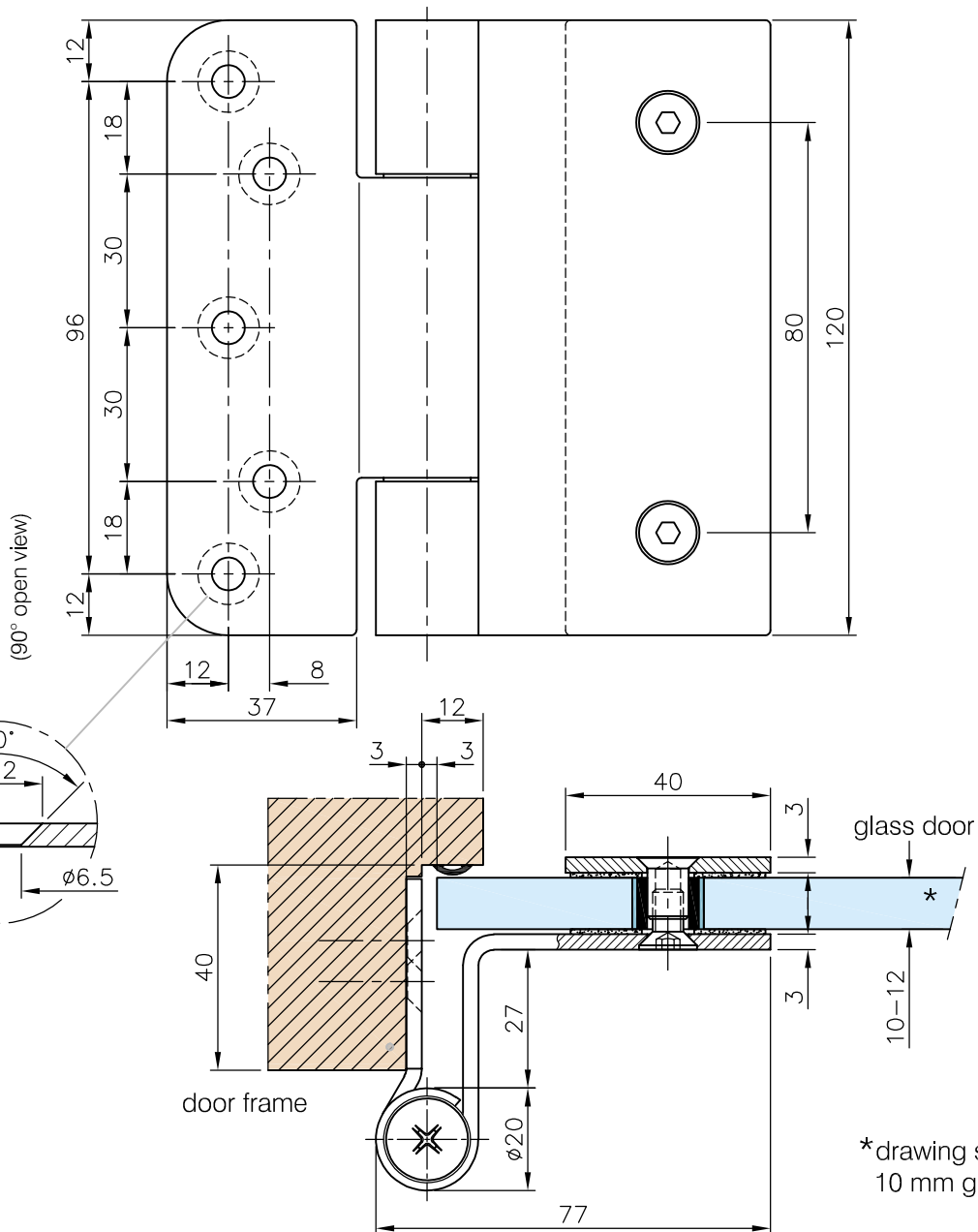

Art. 45.2702.000.10

Art. 45.2702.000.12

Art. 45.2702.000.26

Stand 09.2019

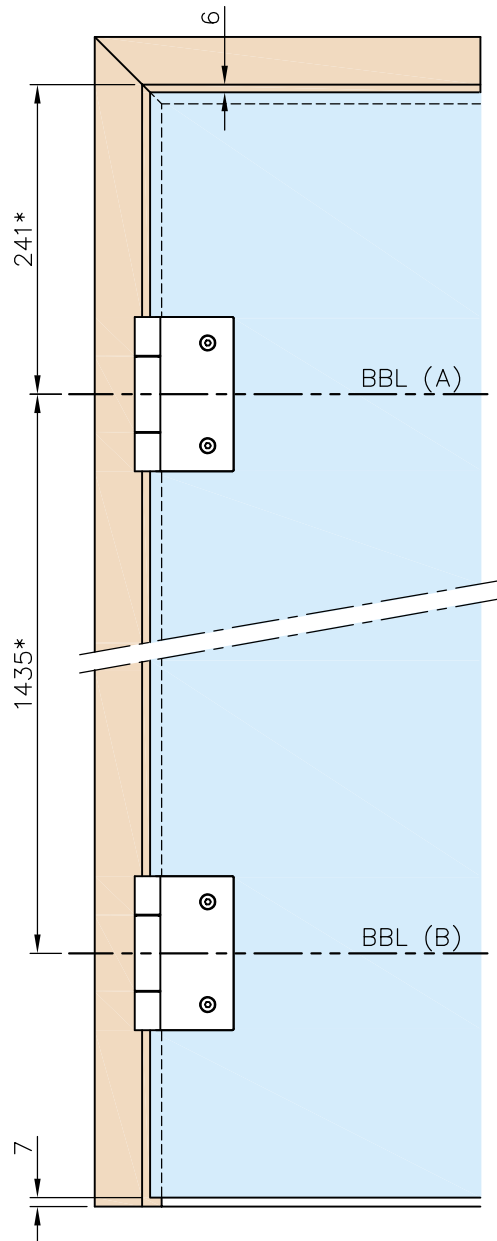
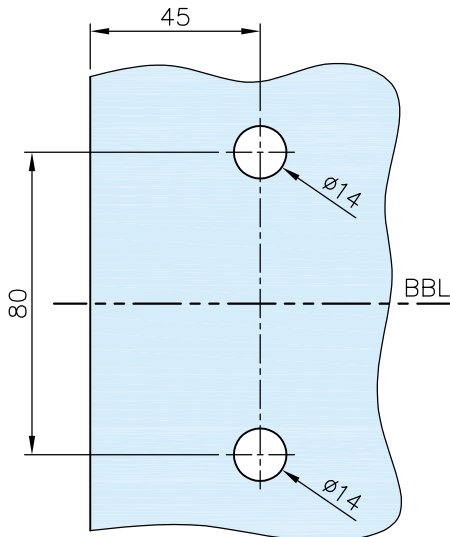
Glasbearbeitung:
 Glass preparation:

Empfehlungsmaße entsprechend *DIN 18268
 Recommended dimensions according to *DIN 18268

<i>Glastürhöhe</i> <i>Glass door height</i>	<i>Abstand</i> <i>Zargenfalz - BBL(A)</i> <i>distance</i> <i>frame rebate - BBL(A)</i>	<i>Abstand</i> <i>BBL(A) - BBL(B)</i> <i>distance</i> <i>BBL(A) - BBL(B)</i>
1860 mm - 2110 mm	241 +1 mm	1435 mm ±0,5 mm
2111 mm - 2235 mm	241 +1 mm	1560 mm ±0,5 mm
2236 mm - 2360 mm	241 +1 mm	1685 mm ±0,5 mm

G-FITTINGS GmbH

 Marie-Curie-Straße 16-18
 46446 Emmerich am Rhein

T +49 (0)2822 962 0

F +49 (0)2822 962 221

E sales@g-fittings.com